

# BUILDING AREAS FOR: 13 CORPORATE DRIVE

13 CORPORATE DRIVE

HALFMOON, NEW YORK

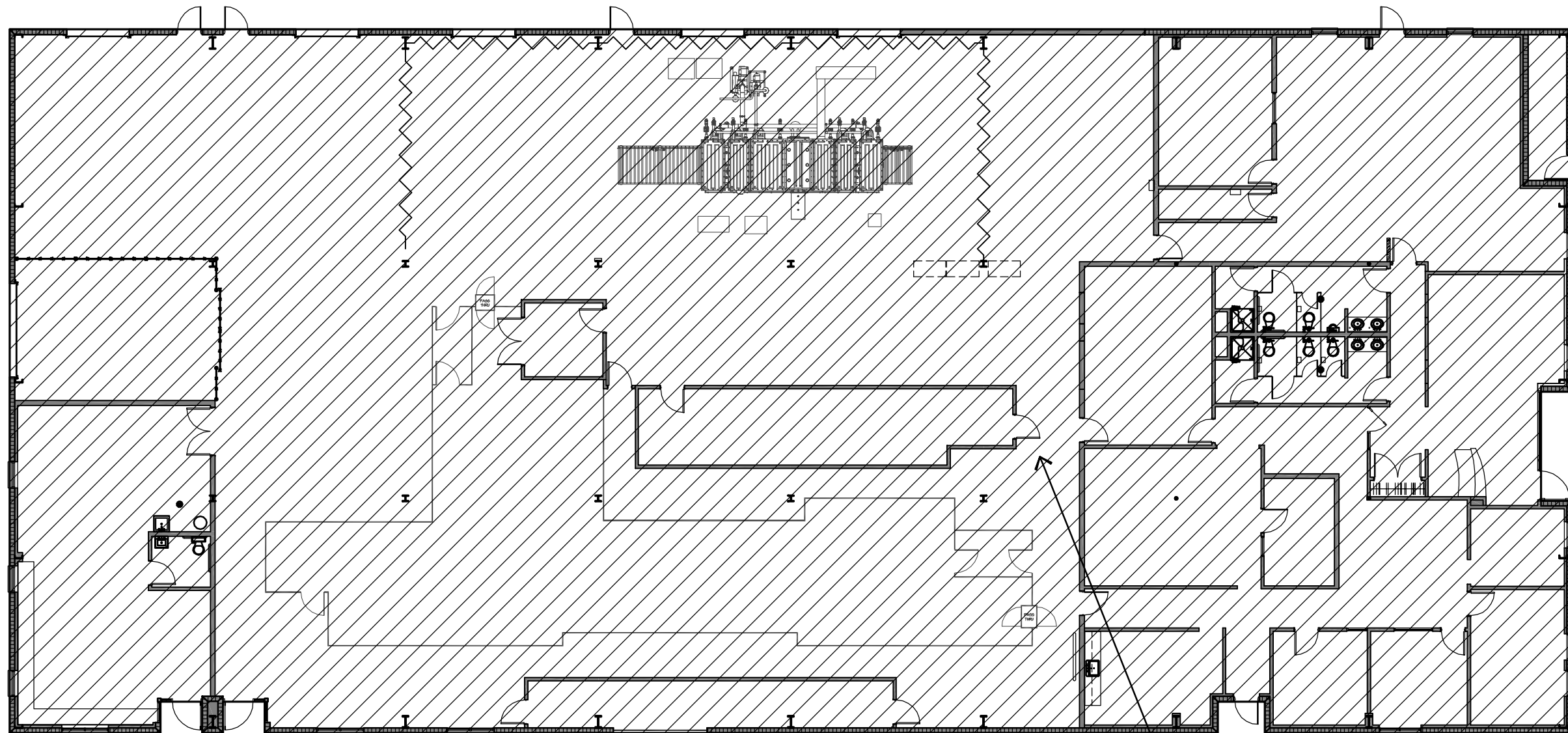

## BUILDING AREA CALCULATIONS:

TENANT #1 USABLE AREA:	± 17,877 S.F.
BUILDING COMMON AREA:	± 0 S.F.
TOTAL BUILDING GROSS AREA (R):	± 17,877 S.F.
BUILDING COMMON AREA PERCENTAGE: (TOTAL COMMON AREA DIVIDED BY TOTAL BUILDING GROSS AREA)	± 0.00%
RENTABLE/USABLE FACTOR (R/U):	1.000

**DRAWING NOTE:**  
DRAWING PREPARED BY INFORMATION  
PROVIDED TO THE ARCHITECT'S OFFICE. ACTUAL  
CONDITIONS SHOULD BE FIELD VERIFIED.

**TENANT SPACE #1**  
USABLE AREA = ± 17,877 S.F.  
(RENTABLE AREA = ± 17,877 S.F.)

## FIRST FLOOR PLAN

SCALE: 1/16" = 1'-0"